

PARIS TO GO

INSTRUCTION MANUAL

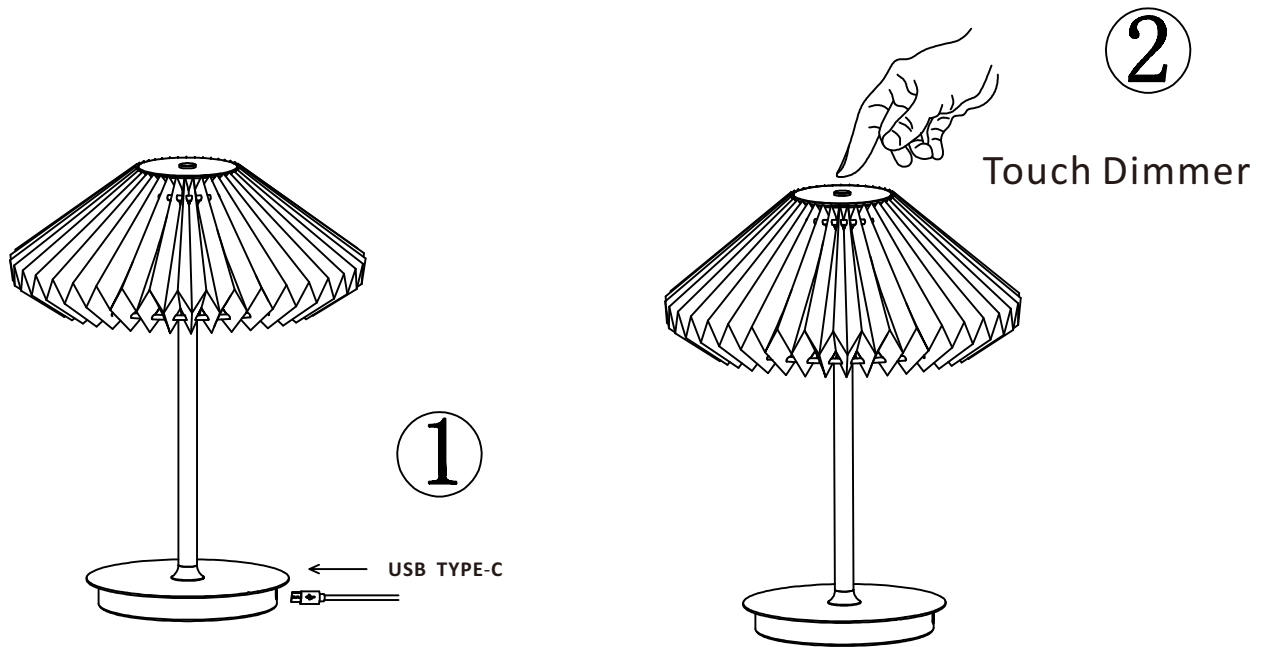

When pressing the on/off indicator, the light will dim up/ down.
During charging, there will be a red indicator lighting. After fully charged it will light green.

Charging time 6-7 Hours
Working time Above 8 Hours

Please remember in case the lamps has not been used for 2-3 months, that the batteries needs to be recharged.

Material:Aluminium/PP/Oak Wood

Used in indoor(IP20)

Halo Design Copenhagen
Gammelgårdsvej 85
DK-3520 Farum
Model no.Paris To Go
2.5W DC 5V 50/60 Hz LED
4000mAh Battery
IP20



halo design

COPENHAGEN