

Package contents (parts are not to scale):

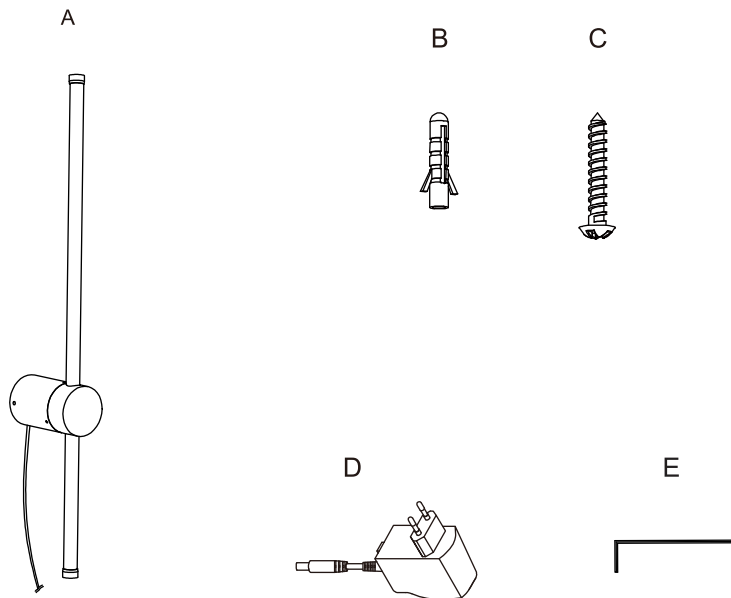

Part	Description	Quantity
A	Fixture body	1
B	Wall expansion particle	2
C	Self-Tapping screw	2
D	LED adaptor plug	1
E	Allen key	1

Light source

Max. LED 12W 600Lumen 3000K (Dimmable)

(Lamp gurantee: 3 years)

Care and Cleaning

EXTERIOR MAINTENANCE

1. To clean the outside of the fixture, use a dry or slightly dampened clean cloth (use clean water, never a solvent) to wipe the surface of the fixture.
2. Do not use any cleaners with chemicals, solvents or harsh abrasives. Use only a dry soft cloth to dust or wipe carefully.

INTERIOR WALL LAMP

Art Nr. 42800-060-02

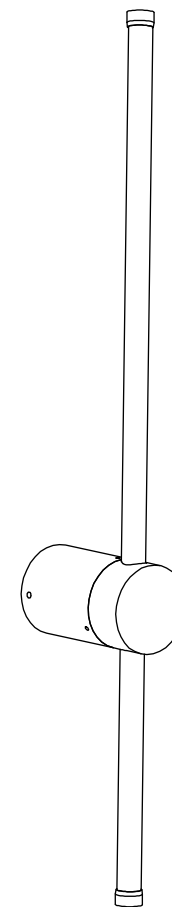

Pre-Installation

PLANNING THE INSTALLATION

Read all instructions before assembly and installation. Before starting installation of the fixture or removal of a previous fixture, disconnect the power by turning off the circuit breaker or by removing the fuse at the fuse box. To avoid damaging this product, assemble it on a soft, non-abrasive surface such as carpet or cardboard.

TOOLS REQUIRED

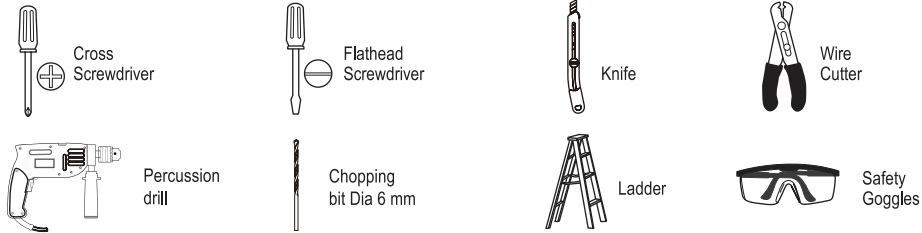

Installation

Step 1.

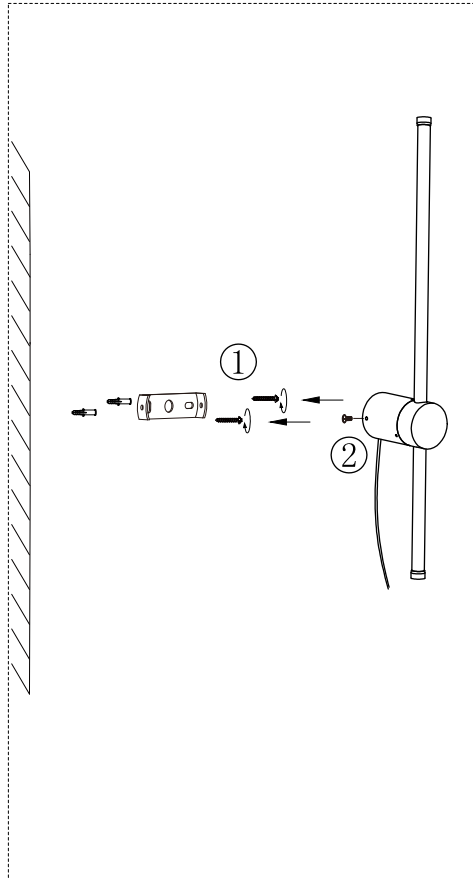

Step 2.

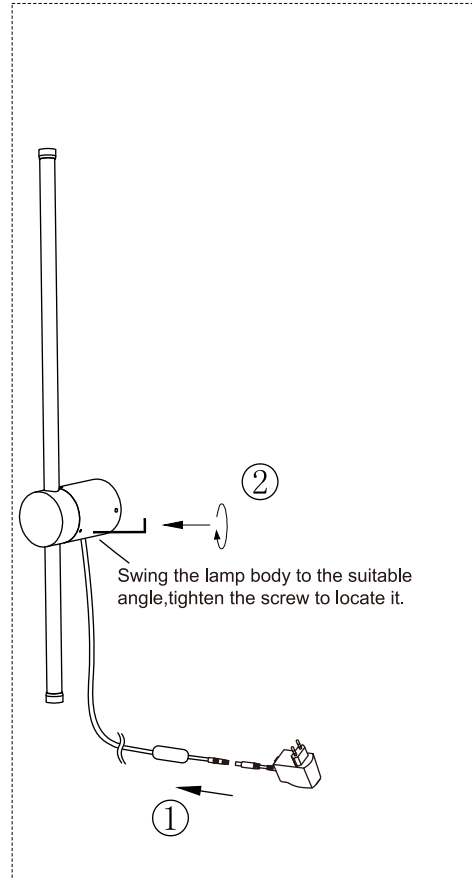

Installation (continued)

Step 1.

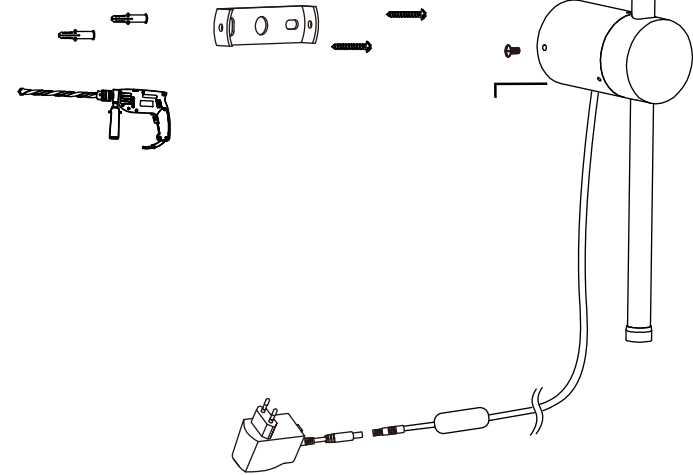

Step 2.

Operation

- Turn on power at the circuit breaker or fuse box.
- Turn the light switch on to activate the fixture.